

TOWN AND COUNTRY PLANNING (SCOTLAND) ACT 1997

THE WEST LOTHIAN COUNCIL (DEANS SOUTH PHASES 3 AND 4,
LIVINGSTON) (STOPPING UP) ORDER 2025

The West Lothian Council, in exercise of the powers conferred on them by Sections 207 and 208 of the Town and Country Planning (Scotland) Act 1997, ("the 1997 Act") and of all other powers enabling them in that behalf, and being satisfied that it has become necessary to authorise the stopping up of the lengths of road and footpaths specified in the Schedule to this Order in order to enable development to be carried out in accordance with planning permission granted under Part III of the said 1997 Act, and having complied with the provisions of Section 209 of the said Act hereby make the following Order:-

1. This Order may be cited as "The West Lothian Council (Deans South Phases 3 and 4, Livingston) (Stopping Up) Order 2025" .
2. The Interpretation Act 1978 shall apply for the interpretation of this Order as it applies for the interpretation of an Act of Parliament.
3. Whereas West Lothian Council being satisfied that it has become necessary to authorise the stopping up of the lengths of road and footpath specified in the Schedule to this Order to enable development to be carried out in accordance with Planning Permission granted under Part III or Section 242A of the 1997 Act.
4. The stopping up of the lengths of road and footpath in West Lothian specified in the Schedule to this Order, is hereby ordered
5. Where there is, immediately before the date on which the said lengths of road and footpath are stopped up under this Order, any apparatus belonging to any statutory undertakers under, in, on, over, across or along the lengths of road and footpath for the purpose of carrying on their undertaking, the said statutory undertakers shall after commencement of this Order continue to have all rights in respect of the said apparatus as they had immediately before that date.

Given under the Seal of The West Lothian Council at Livingston on the Third day of April Two Thousand and Twenty five.

Proper Officer

SCHEDULE

LENGTHS OF FOOTPATH IN DEANS, LIVINGSTON TO BE STOPPED UP

From the western kerb line of Deans South located 27 metres or thereby north of the projected northern kerb line of Bute westward for 21 metres or thereby then northward for 82 metres or thereby.

This order was confirmed as unopposed
by West Lothian Council at Livingston
on the Third day of July Two Thousand
and Twenty Five and will come into force
on 11th July 2025

From a point located 27 metres or thereby north along Deans South from the projected northern kerb line of Bute and 27 metres or thereby west and 16 metres or thereby north, westward for 34 metres or thereby, then southward for 37 metres or thereby, then westward for 18 metres or thereby including an area of 22 square metres.

From a point located 27 metres or thereby north along Deans South from the projected northern kerb line of Bute and 27 metres or thereby west and 38 metres or thereby north, westward for 53 metres or thereby, then northward for 4 metres or thereby, then westward for 25 metres or thereby.

From the western kerb line of Deans South located 5 metres or thereby along the north kerb line of Bute northward for 96 metres or thereby.

From the western kerb line of Deans South located 57 metres or thereby north of the projected northern kerb line of Bute westward for 4 metres or thereby.

From the western kerb line of Deans South located 87 metres or thereby north of the projected northern kerb line of Bute westward for 2 metres or thereby.

From the western kerb line of Deans South located 5 metres or thereby along the south kerb line of Bute southward for 46 metres or thereby.

From a point located 5 metres or thereby along the south kerb line of Bute from the western kerb line of Deans South and 6 metres or thereby southward, westward for 20 metres or thereby.

From a point located 26 metres south of the projected south kerb of Deans South on the east side of Arran eastward for 46 metres or thereby.

From a point on the southern kerb line of Bute located 27 metres or thereby west of the projected west kerb of Deans South southward for 49 metres or thereby.

From a point on the southern kerb line of Bute located 32 metres or thereby west of the projected west kerb of Deans South and 28 metres or thereby south, westward for 50 metres or thereby.

From a point located 2 metres south of the projected south kerb line of Deans South on the west side of Arran southwards for 38 metres or thereby.

From a point located 3 metres south of the projected south kerb line of Deans South on the east side of Arran southwards for 22 metres or thereby.

From a point located 29 metres south of the projected south kerb line of Deans South on the west side of Arran and 29 metres or thereby west westward for 14 metres or thereby.

From a point located 41 metres south of the projected south kerb line of Deans South on the west side of Arran and 21 metres or thereby westward, southwards for 137 metres or thereby.

From a point located 3m west of the southwest kerb corner of Bute and 49 metres or thereby north, eastward for 18 metres or thereby then northward for 4 metres or thereby and east for 11 metres or thereby.

From 3 metres or thereby east of the southeast corner of Arran, southward for 20 metres or thereby.

From a point located 3 metres or thereby west of the southwest kerb corner of Bute and northward for 51 metres or thereby, then eastward for 19 metres or thereby.

From a point 90 metres or thereby west of the projected west kerb line of Jura along Deans South, northward for 34 metres or thereby then eastward for 21 metres or thereby then northward for 41 metres or thereby.

From a point 64 metres or thereby west of the projected west kerb line of Jura along Deans South, northward for 48 metres or thereby then eastward for 53 metres or thereby.

From a point 10 metres or thereby west of the projected west kerb line of Jura along Deans South, northward for 75 metres or thereby then westward for 54 metres or thereby.

From a point 10 metres or thereby west of the projected west kerb line of Jura along Deans South and north for 21 metres or thereby, westward for 54 metres or thereby.

From a point 12 metres or thereby east of the projected kerb line of Jura along Deans South round the east radius of Jura and northward for 23 metres or thereby then north-eastward for 25 metres or thereby then north-westward for 31 metres or thereby then northward for 10 metres or thereby.

From a point 44 metres or thereby northward along east kerb line of Jura from Deans South
At a point 26 metres or thereby south of the projected south kerb line of Bute on the east kerb line of Deans South, eastward for 8 metres or thereby, then 30 metres or thereby south, then 25 metres or thereby west and 13 metres or thereby south.

At a point 26 metres or thereby south of the projected south kerb line of Bute and 8 metres or thereby east of the east kerb line of Deans South, eastward for 21 metres or thereby, then southward for 42 metres or thereby.

From a point 12 metres or thereby west of the south eastern corner of the parking area 12 metres southeast of Bute, eastward for 21 metres or thereby, then southward for 16 metres or thereby.

At a point 13 metres or thereby south of the projected south kerb line of Bute and 5 metres or thereby east of the east kerb line of Deans South, north eastward for 8 metres or thereby, then 39 metres or thereby eastward, then northward for 22 metres or thereby, then northwest for 3 metres, then northward for 25 metres or thereby, then eastward for 6 metres or thereby, then northward for 25 metres or thereby, then westward for 7 metres or thereby, then northward for 27 metres or thereby.

At a point 8 metres or thereby north of the projected north kerb line of Bute and 2 metres east of the east kerb line of Deans South, eastward for 40 metres or thereby.

At a point 25 metres or thereby north of the projected north kerb line of Bute and 2 metres east of the east kerb line of Deans South, eastward for 40 metres or thereby.

At a point 61 metres or thereby north of the projected north kerb line of Bute and 2 metres east of the east kerb line of Deans South, eastward for 37 metres or thereby.

At a point 6 metres or thereby east of the projected east kerb line of Staffa on the southern kerb line of Deans South, southward for 7 metres or thereby.

At a point 31 metres or thereby east of the projected east kerb line of Staffa on the southern kerb line of Deans South and 5 metres south, westward for 71 metres or thereby.

At a point 31 metres or thereby east of the projected east kerb line of Staffa on the southern kerb line of Deans South and 5 metres south and 53 metres or thereby west, northward for 8 metres or thereby.

At a point 31 metres or thereby east of the projected east kerb line of Staffa on the southern kerb line of Deans South and 5 metres south and 5 metres or thereby west, southward for 36 metres or thereby.

At a point 31 metres or thereby east of the projected east kerb line of Staffa on the southern kerb line of Deans South and 5 metres south and 53 metres or thereby west, southeast for 9 metres or thereby, then northeast for 7 metres or thereby.

From the southeast corner of 198 Deans South westward for 28 metres, then northwest for 25 metres.

All as the said lengths of footpath are shown hatched in black on the plans 1 and 2 annexed and executed as relative to this Order.

LENGTHS OF ROAD IN DEANS, LIVINGSTON TO BE STOPPED UP

Bute	For its entire length of 108 metres or thereby from 5 metres or thereby west of the projected west kerb line of Deans South. The carriageway width varies. Total area of 785 square metres.
Arran	For its entire length of 83 metres or thereby from 5 metres or thereby south of the projected south kerb line of Deans South. The carriageway width varies. Total area of 732 square metres.
Jura	For its entire length of 148 metres or thereby. Total area of 1432 square metres
Staffa	For its entire length of 106 metres or thereby from 5 metres or thereby north of the projected north kerb line of Deans South. The carriageway width varies. Total area of 1063 square metres.
Parking area 12 metres Southeast of Bute	For its entire length of 64 metres or thereby from a point 12 metres south or thereby of the projected southern kerb line of Bute and 2 metres east of the eastern kerb line of Deans South. The carriageway width varies. Total area of 634 square metres.

All as the said lengths of road are shown cross hatched in black on the plans 1 and 2 annexed and executed as relative to this Order.

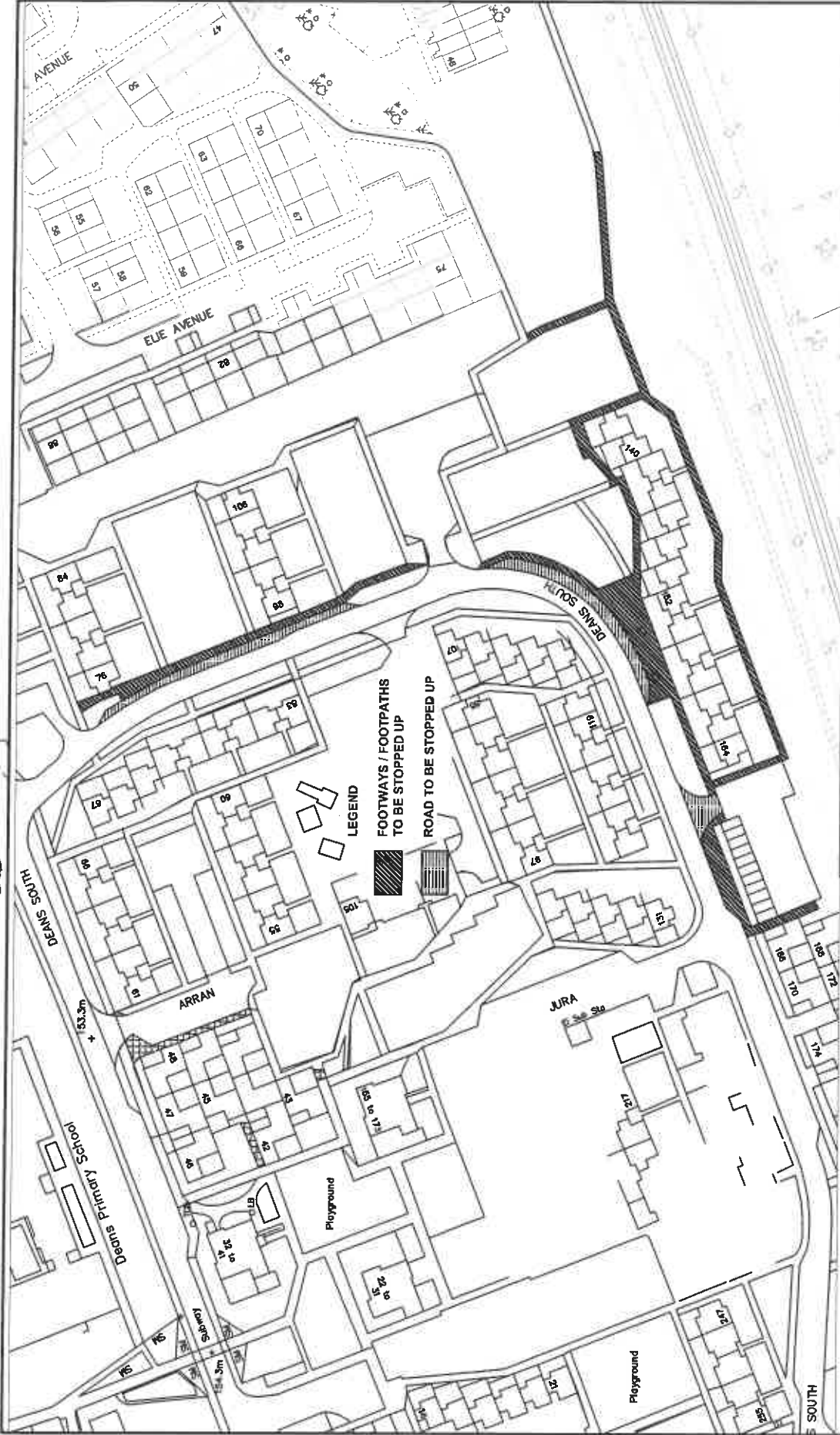

This is plan 1 referred to in The West Lothian Council (Deans South Phases 3 and 4, Livingston) (Stopping Up) Order 2025

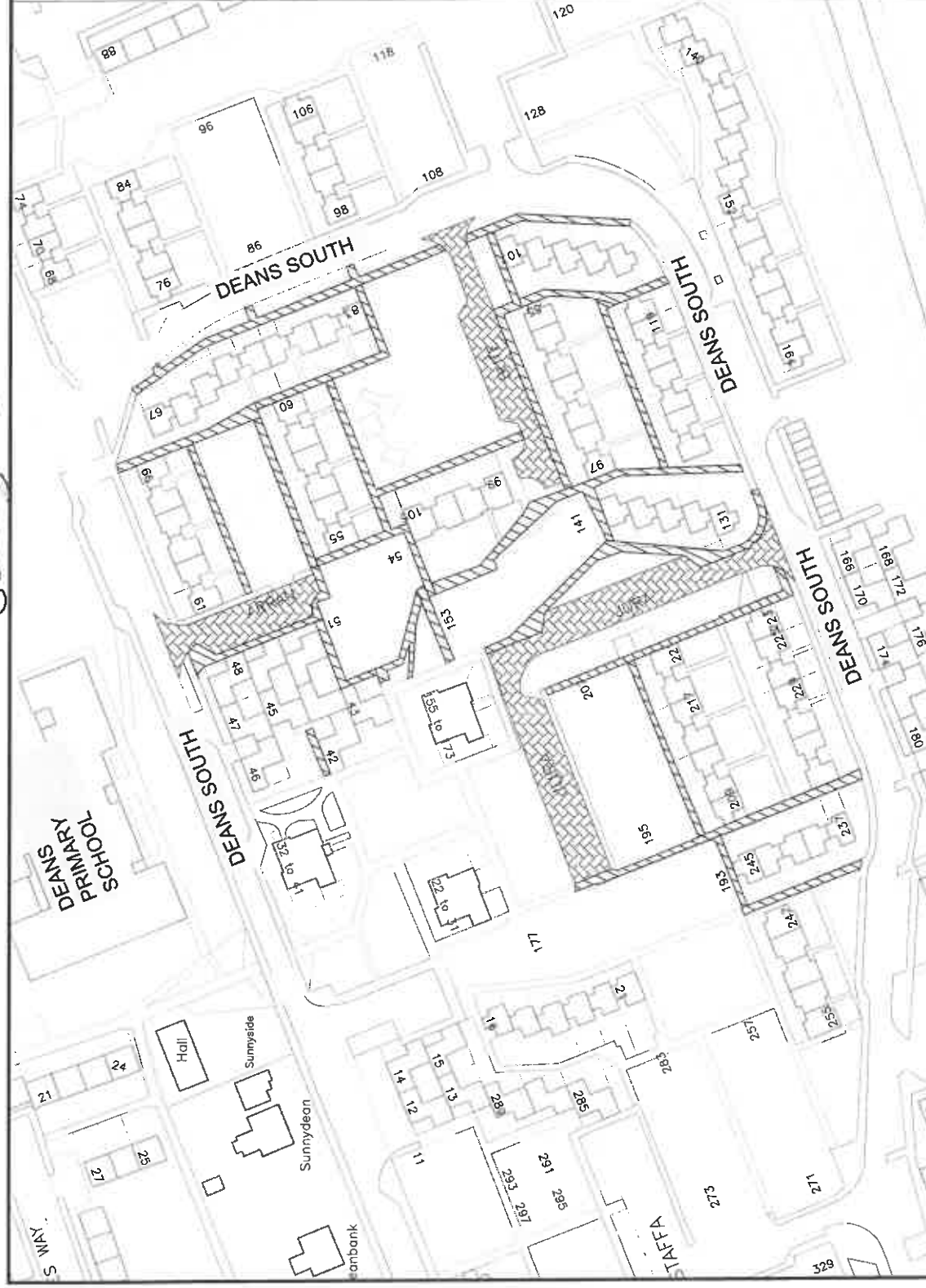

DATA LABEL:- Public		WEST LOTHIAN COUNCIL OPERATIONAL SERVICES		Footpaths and Road Phase 4 Stopping Up Locations	
Based upon the Ordnance Survey mapping with the permission of the Controller of Her Majesty's Stationery Office © Crown copyright. Unauthorized reproduction infringes Crown copyright and may lead to prosecution or civil proceedings. Licence No.: LA09052L		ROADS & TRANSPORTATION MANAGER WHITEHILL SERVICE CENTRE BATHGATE EH48 2EP TEL 01506 282351	TRANSPORTATION Transport Planning & Development Management	DATE:- August 2018	DRAWN BY:- Chris Nicol
				SCALE:- NTS	CHECKED BY:- Jim Stewart
				Drg. No.:- DP/Liv/06	



LEGEND

- | | |
|---|--|
|  | Footpaths / Footways
to be stopped up |
|  | Carrigeway to be
stopped up |

NOTES

- 1) This plan reflects the road / footway / plot arrangement prior to the re-development of this area

DATA LABEL:- Public / Internal / Protect / Classified

Based upon the Ordnance Survey mapping with the permission of the Controller of Her Majesty's Stationery Office © Crown copyright. Unauthorized reproduction infringes Crown copyright and may lead to prosecution or civil proceedings.

**WEST LOTHIAN COUNCIL
OPERATIONAL SERVICES**

ROADS & TRANSPORTATION MANAGER WHITEHILL SERVICE CENTRE WHITEHILL INDUSTRIAL ESTATE BATHURST, N.S.W.	TRANSPORTATION D.M.T.P
---	---------------------------

PROPOSED STOPPING UP ORDER
DEANS SOUTH AREA
LIVINGSTON

DATE:-	NOV 2024	DRAWN BY:-	W. C
SCALE:-	N.T.S	CHECKED BY:-	C. N

DMTP/TRO/LIV/STO/001

